



CITY OF HOBART

# MINUTES ATTACHMENTS

**CITY PLANNING COMMITTEE MEETING**

**OPEN PORTION OF THE MEETING**

**MONDAY, 24 JANUARY 2022**

**AT 5:00 PM**

**VENUE: VIA ZOOM**

---

## TABLE OF CONTENTS

---

7.1.2	1/816 Sandy Bay Road, Sandy Bay and Common Land or Parent Title - Partial Demolition, Alterations and Extension	
A.	Cedric Manen - Deputation Supporting Information - 1/816 Sandy Bay Road.....	2
7.1.4	1-7 Cedar Court, Sandy Bay Adjacent Road Reserve - Partial Demolition, Alterations, Extension, Front Fencing, Garage, Alteration to Access, and Associated Works	
A.	Benn Turner - Deputation Supporting Information - 1-7 Cedar Court .....	5

---

Pictures to accompany Cedric Manen – Deputation – Agenda 7.1.2

Natural sunlight will be fully blocked by proposed development – this is a picture taken mid winter | no shadowing diagrams



Driveway has a large drop off to our front yard with no suitable retaining walls

---



Existing wooden retaining walls on driveway not sufficient to accommodate additional traffic on premises and poses a risk to neighbours and residents



Existing retaining walls will need to be strengthened/replaced as they are not adequate to support new two storey structure



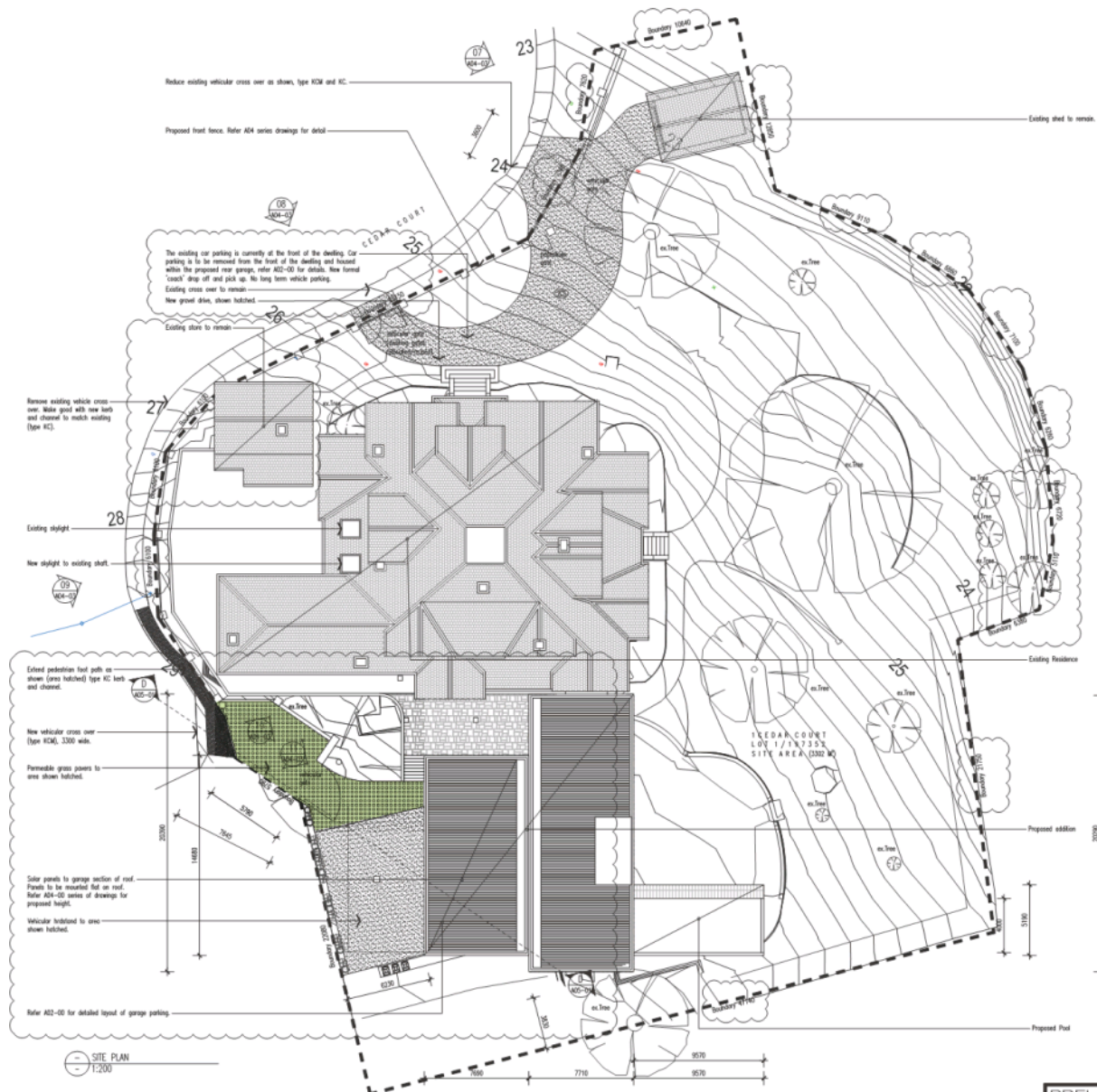

SITE PLAN  
1:200

PRELIMINARY NOT FOR CONSTRUCTION

COURTNEY L. MCGIBBON (PRACTISING ARCHITECT) 2010



Client  
40 Gwendolen Street (Sublot) 2167 7000  
TAS 7100 010  
ARC-COURTNEY  
Subcontractor  
3 Dink Road South, Tasma 7163  
TAS 7160 000  
info@prestonlane.com.au  
prestonlane.com.au

This drawing is for information only and is not to be used for any other purpose without the written consent of the author. It is not to be used for any other purpose without the written consent of the author.



Project: NOVIA AND VARIETY TRAIL  
Site: 1 CEDAR COURT, SALLY BAY  
Drawing: SITE PLAN  
Scale: 1:200 @ A2

NO.	DESCRIPTION	DATE	BY
1	ISSUED FOR PERMIT	18/12/2021	CM
2	ISSUED FOR PERMIT	18/12/2021	CM
3	ISSUED FOR PERMIT	18/12/2021	CM
4	ISSUED FOR PERMIT	18/12/2021	CM
5	ISSUED FOR PERMIT	18/12/2021	CM
6	ISSUED FOR PERMIT	18/12/2021	CM
7	ISSUED FOR PERMIT	18/12/2021	CM
8	ISSUED FOR PERMIT	18/12/2021	CM

Drawing Number: 20080  
A00-02

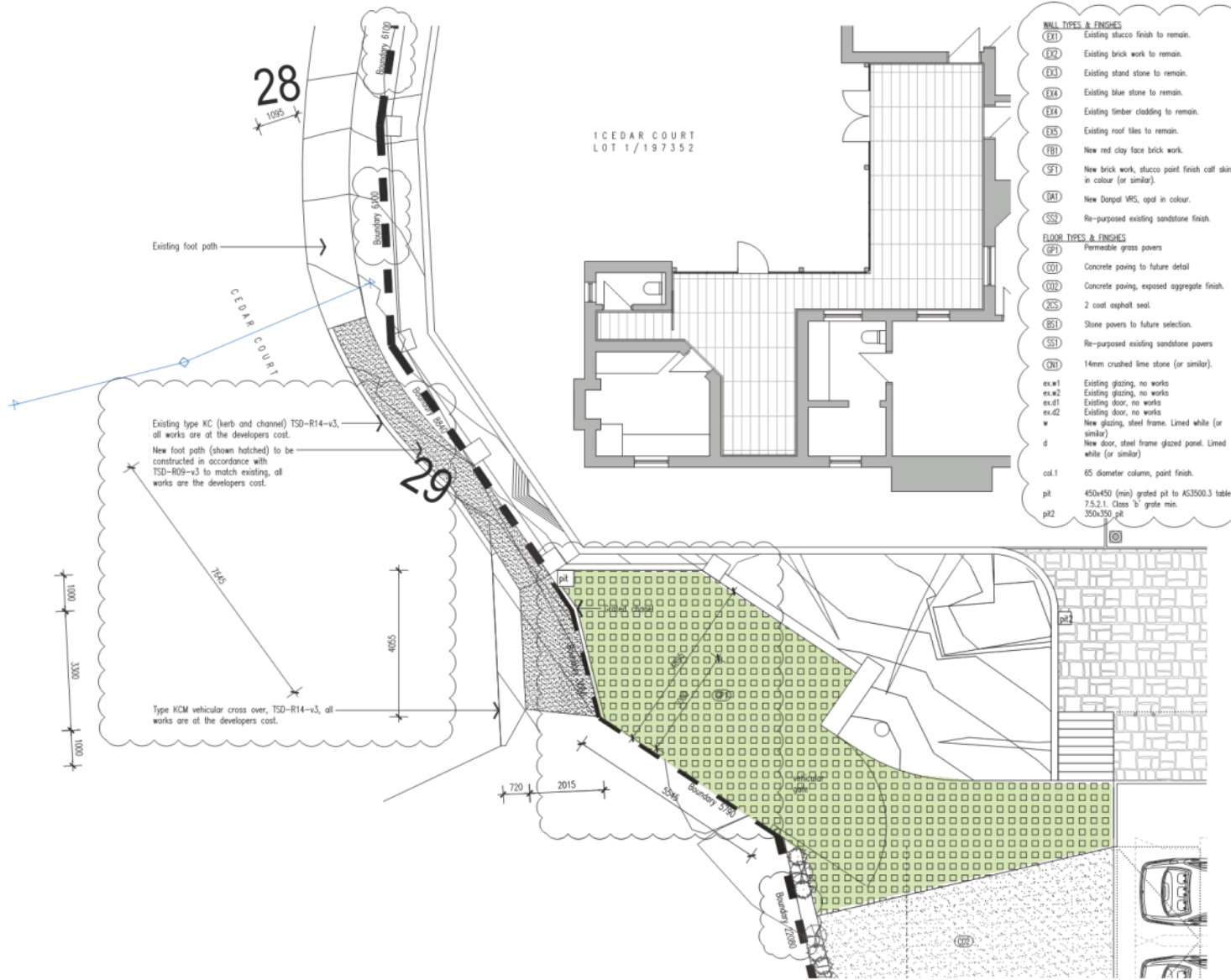

NOTE  
Refer drawing A00-03 for location.

LOCATION OF ALL NEIGHBOURING STRUCTURES ARE INDICATIVE ONLY



**Hobart**  
45 Gordon Street Hobart TAS 7000  
T 61 3 6251 2923  
ACC CC38197

**Melbourne**  
9 Trevell Road South Yarra VIC 3141  
T 61 3 9627 8923  
info@prestonlane.com.au  
prestonlane.com.au

The Builder/Contractor shall verify job dimensions prior to any work commencing. If agreed dimensions shall take precedence over scaled work.

No part of this drawing shall be reproduced or otherwise dealt with without the prior written consent of Preston Lane.



Proprietor: **NOVA AND VAHINI THAM**

Project: **1 CEDAR COURT SANDY BAY**

Drawing: **FLOOR PLAN GROUND FLOOR**

Scale: **1:100 @ A3**

Revision	By	Date	Description
R1	BT	28/05/2021	issued for client approval
R2	BT	31/05/2021	issued for SA
R3	BT	21/06/2021	issued for DM consultant
R4	BT	01/07/2021	DM consultant #1 response
R5	BT	01/11/2021	issued for client approval
R6	BT	10/11/2021	SA-R1 response

Project No: **20090**

Drawing Number: **A02-03**

PART FLOOR PLAN  
1:100

PRELIMINARY NOT FOR CONSTRUCTION

