

NEW TOWN RETAIL PRECINCT UPGRADE

The City of Hobart is seeking feedback from the community on the streetscape concept for the New Town Retail Precinct upgrade project.

The concept designs have been developed by the City of Hobart in response to community-identified visions for the precinct. Many New Town people contributed by responding to surveys, attending workshops, participating in school visioning activities - and a 23 member project action team comprising residents and traders provided recommendations to the Council outlining the community's highest priorities for the project.

The upgrade will make the New Town Retail Precinct a more accessible and attractive community place. The proposal includes improved pedestrian crossing facilities on New Town Road and the side streets, renewed footpaths and new street furniture. Street trees and plantings will soften the appearance of the main street and public art and heritage interpretation will enhance New Town's sense of identity.

Find out more and have your say:

Consultation on the concept designs will be open until Friday 13 April 2018.

On-line

To find out more and fill in a survey visit:
yoursay.hobartcity.com.au/newtownprecinct

Pop up exhibition

City officers will be 'setting up shop' in the vacant premises on the corner of Roope Street and New Town Road and the community is invited to come and view the plans, meet project officers and participate in activities at the following times:

4-7pm	Thursday 15 March 2018
10am-7pm	Friday 16 March 2018
10am-4pm	Saturday 17 March 2018



The Project Action Team

Still have questions?

Contact the project manager, Sarah Bendeich, Infrastructure Planner on telephone 6238 2584 or email coh@hobartcity.com.au

Frequently asked questions

Why are the bus stops changing? Two bus stops will be removed to improve efficiency of buses travelling along the high-frequency route. CoH officers are working with Department of State Growth and Metro to coordinate the changes.

Will there be any loss of on-street car parking? Some parking spaces will be removed to provide safe pedestrian crossings, however new spaces will be created when two bus stops are removed.

What bicycle infrastructure will be provided? New Town Rd is part of Hobart's northern priority

route for bicycles, however there are constraints to providing bike lanes due to the busy nature of the road, the need for on-street car parking to support retail businesses and the road width. Hobart's Bicycle Advisory Committee will consider a plan to identify and signpost alternative routes, to complement to the streetscape upgrade project.

When will works happen? Construction is planned for 2019.

Will there be public art and interpretation? Yes. Public art will be developed concurrently and

details of this exciting project will be revealed soon. Heritage interpretation will also be included, in recognition of the community's strong desire to express the distinctive history and character of the New Town in the activity area.

Will there be changes to speed limits? The State Government is responsible for approving changes to speed limits. After the streetscape changes have been implemented, traffic speeds would be monitored and speed limit changes considered then, in consultation with the community.

Streetscape concept - summary of overall scheme

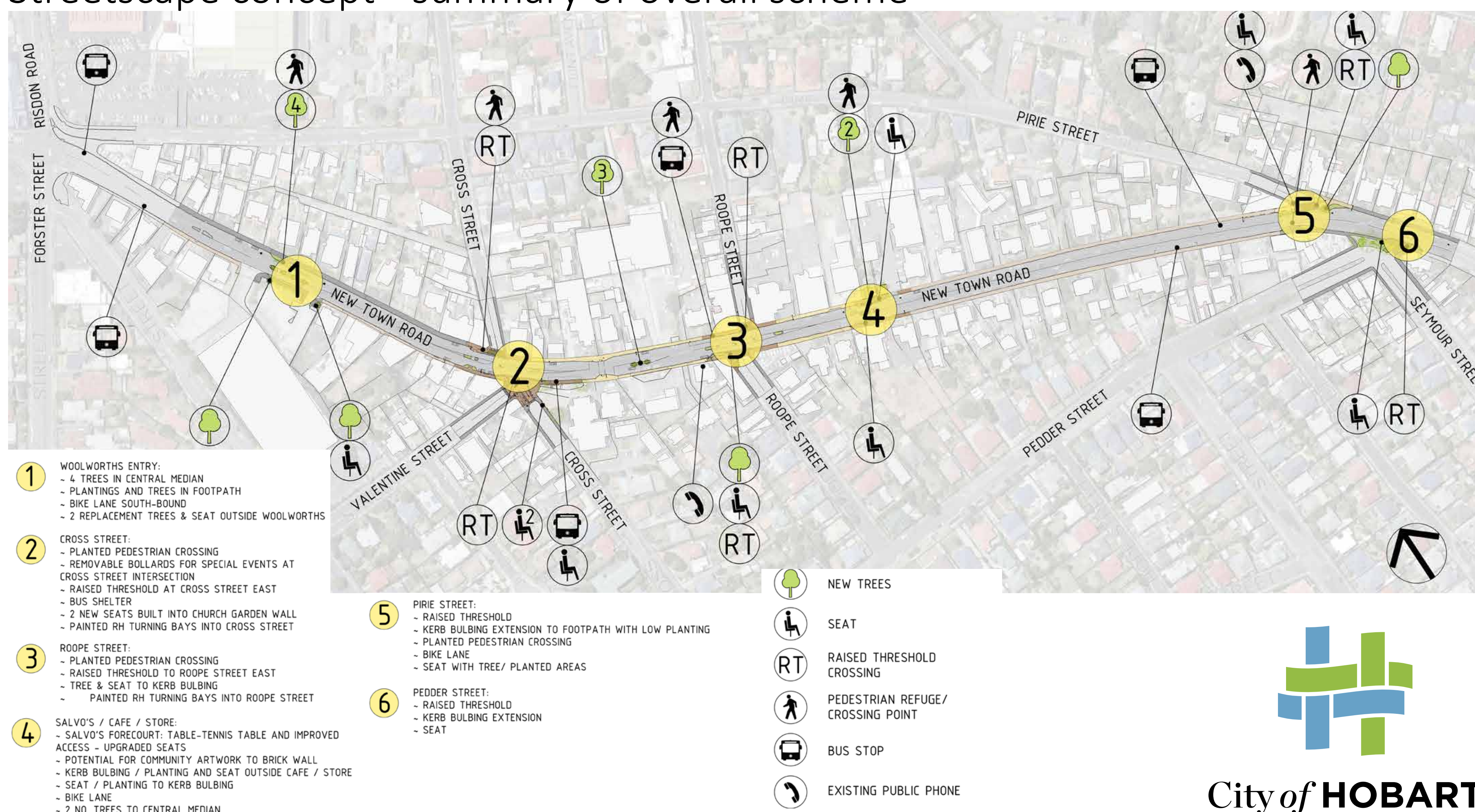

City of HOBART

NEW TOWN RETAIL PRECINCT UPGRADE

Changes to bus stops



A new inbound bus stop is proposed for this location. It would replace the bus stop on the north side of Risdon Road, providing improved access to New Town Plaza and opportunity for a shelter and seating.

The inbound bus stop near King Wah Chinese Restaurant will be removed.



The inbound bus stop near the Skin Cancer Clinic will remain. The shop awning provides shelter. Seating will be enhanced.

The inbound bus stop near Pirie Street, close to Dapper Dog Grooming will remain. The shop awning provides shelter. New seating is proposed.



The outbound bus stop near Rams Home Loans will remain.



The outbound bus stop near Risdon Road will remain.

The outbound bus stop near Cross Street, adjacent to the historic church property, will remain. A new shelter and seating is proposed, in consultation with the property owner.



The outbound bus stop near Roope Street, adjacent to New Town Motors, is proposed to be removed.

Find out more & have your say...
on-line: yoursay.hobartcity.com.au/newtownprecinct
or contact the Infrastructure Planner, Sarah Bendeich
telephone: 6238 2584
email: coh@hobartcity.com.au

Pedestrian crossing facilities

Changes are proposed to the **pedestrian crossings** in the New Town retail precinct and these are shown below. Improved pedestrian crossings were consistently a high priority when engaging with the local community.

In addition to the crossings on New Town Road, the side streets will be improved with raised thresholds to provide step free access along the main road.

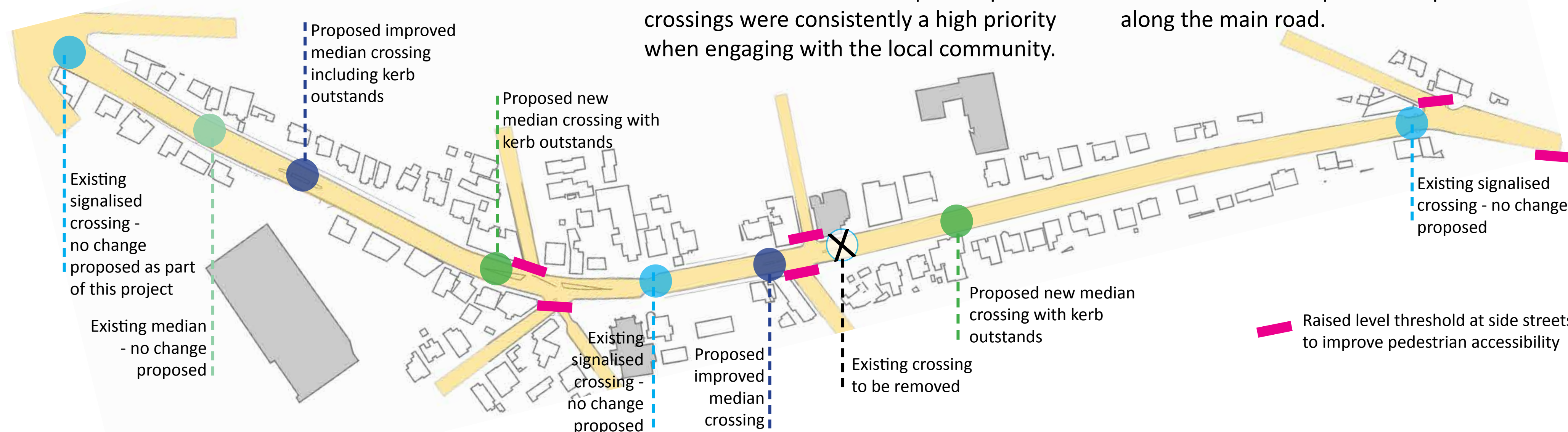

Footpath finishes

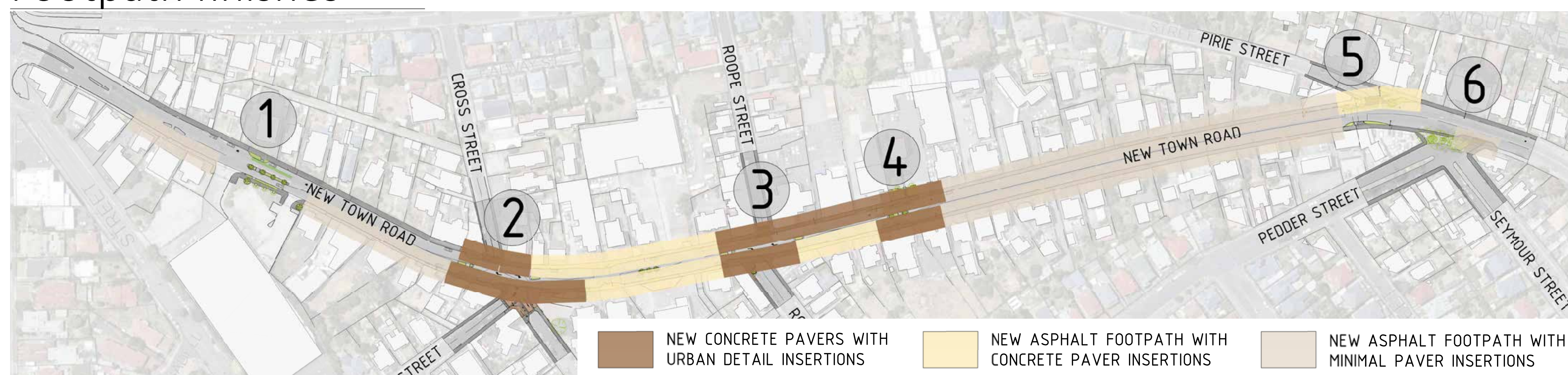

NEW TOWN RETAIL PRECINCT UPGRADE

Streetscape concept - Northern Gateway

1

The **Northern Gateway** to the New Town retail precinct is near Woolworths. The proposed treatment here is to enhance the presentation of the streetscape and improve pedestrian access.

- 1 An improved pedestrian crossing facility** is proposed, with a wider median island and kerb outstands to make the crossing facility more accessible.
- 2 Trees in the central median** and low growing plants in the footpath edges will provide a softer, greener entry point to the busy activity area, calming traffic and defining the gateway.
- 3 A seat and renewed planting** will provide an opportunity for rest (location to be determined in consultation with Woolworths).
- 4 A short section of bicycle lane** avoids a 'pinch point' for cyclists in the uphill direction alongside the median island. Note: a continuous bicycle lane is not proposed.



Find out more & have your say...
yoursay.hobartcity.com.au/newtownprecinct

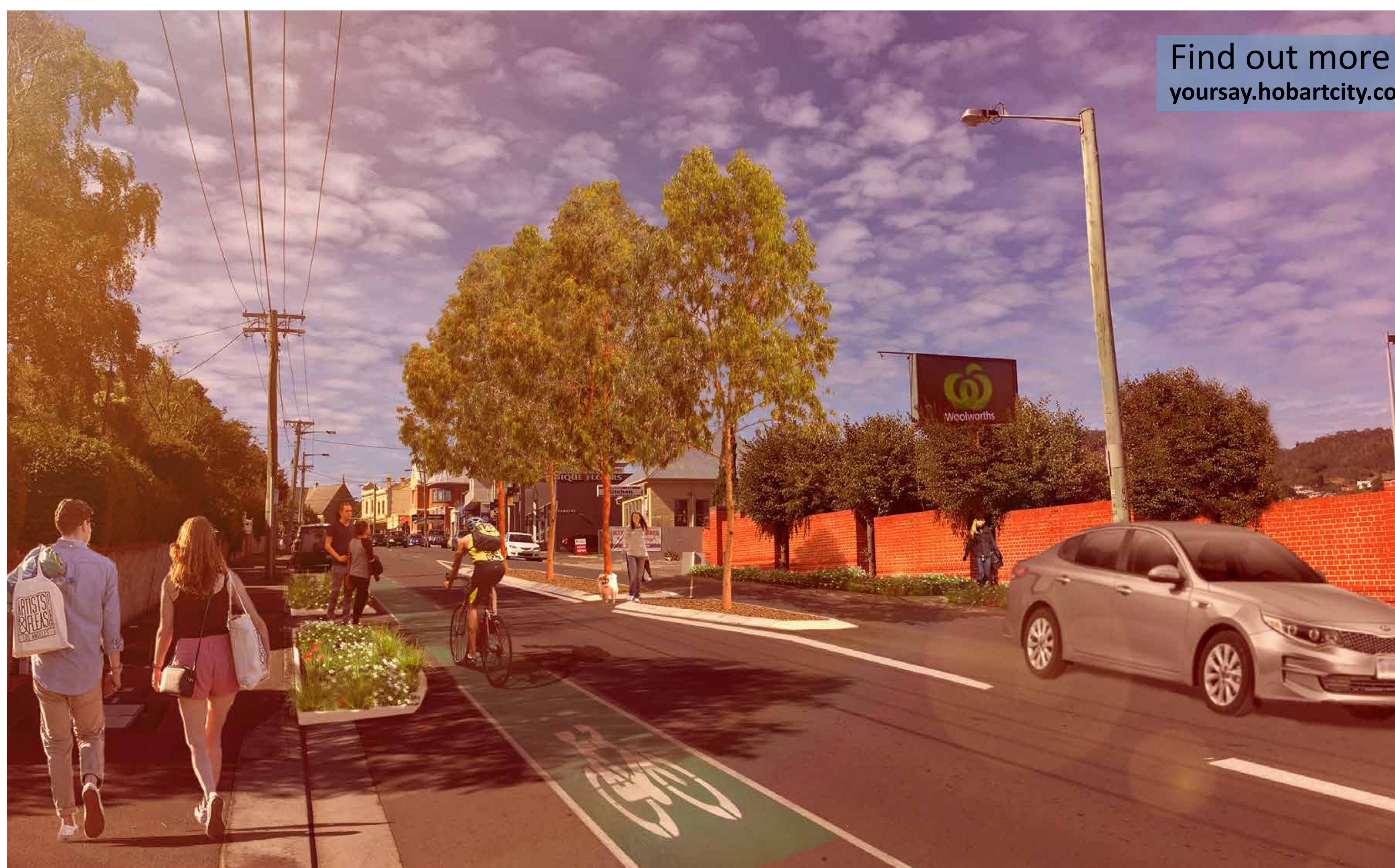

Artist's Impression



City of **HOBART**

2

NEW TOWN RETAIL PRECINCT UPGRADE

Streetscape concept - Cross St junction

Find out more & have your say...
yoursay.hobartcity.com.au/newtownprecinct

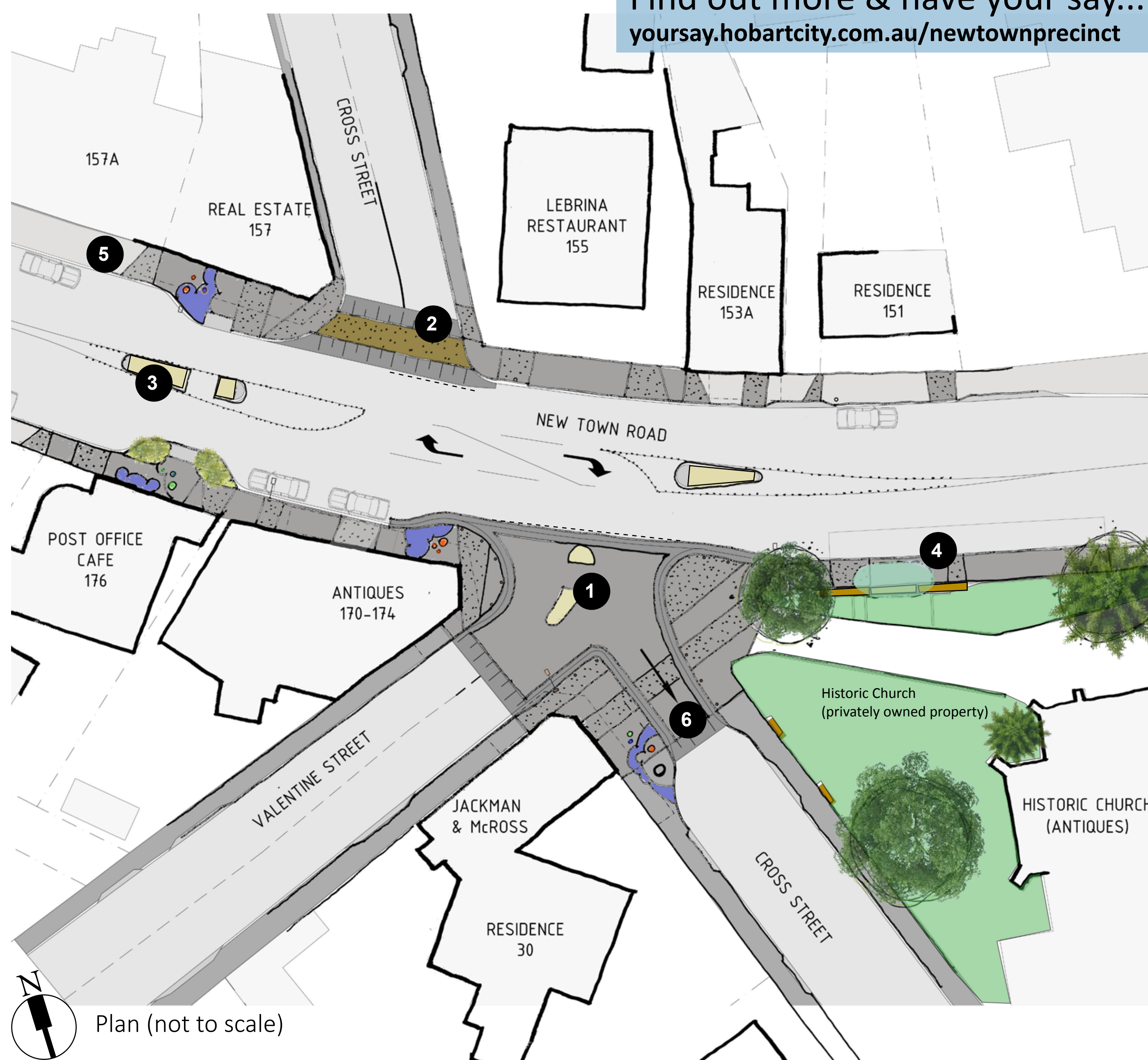

The junction of Cross and Valentine Streets is the **Historic Heart** of New Town. Regular traffic arrangements won't change, however a raised, level platform will be installed where the two side streets converge, with flexible infrastructure allowing the space to be used as a temporary pedestrian zone for community events.

- 1 **A flexible space** is created with a raised, level junction that maintains the existing traffic access. Removable bollards and removable a central island (in Cross St) allow the space to be transformed from roadway to community event and gathering space.
- 2 **A raised threshold** will improve access.
- 3 **A new pedestrian crossing facility** with median island and kerb outstands north of Cross Street will improve access across New Town Road. (The existing pedestrian signalised crossing between Cross Street and Roope Street will be retained.)
- 4 **The outbound bus stop** will remain near Cross Street, and the addition of a new shelter and seating will provide improved conditions for people waiting for the bus. (The specific design will be determined in consultation with the property owner).
- 5 **The inbound bus stop** will be removed from this location. A new stop at Risdon Rd is proposed.
- 6 **A poster pole, bike racks, bin and seating** are proposed for this area. Their locations will be determined in consultation with adjacent property owners and traders.



Artist's Impression
Cross and Valentine St junction - event mode



Bus shelter



Cross and Valentine St junction in day-to-day mode

3

NEW TOWN RETAIL PRECINCT UPGRADE

Streetscape concept - Roope Street junction

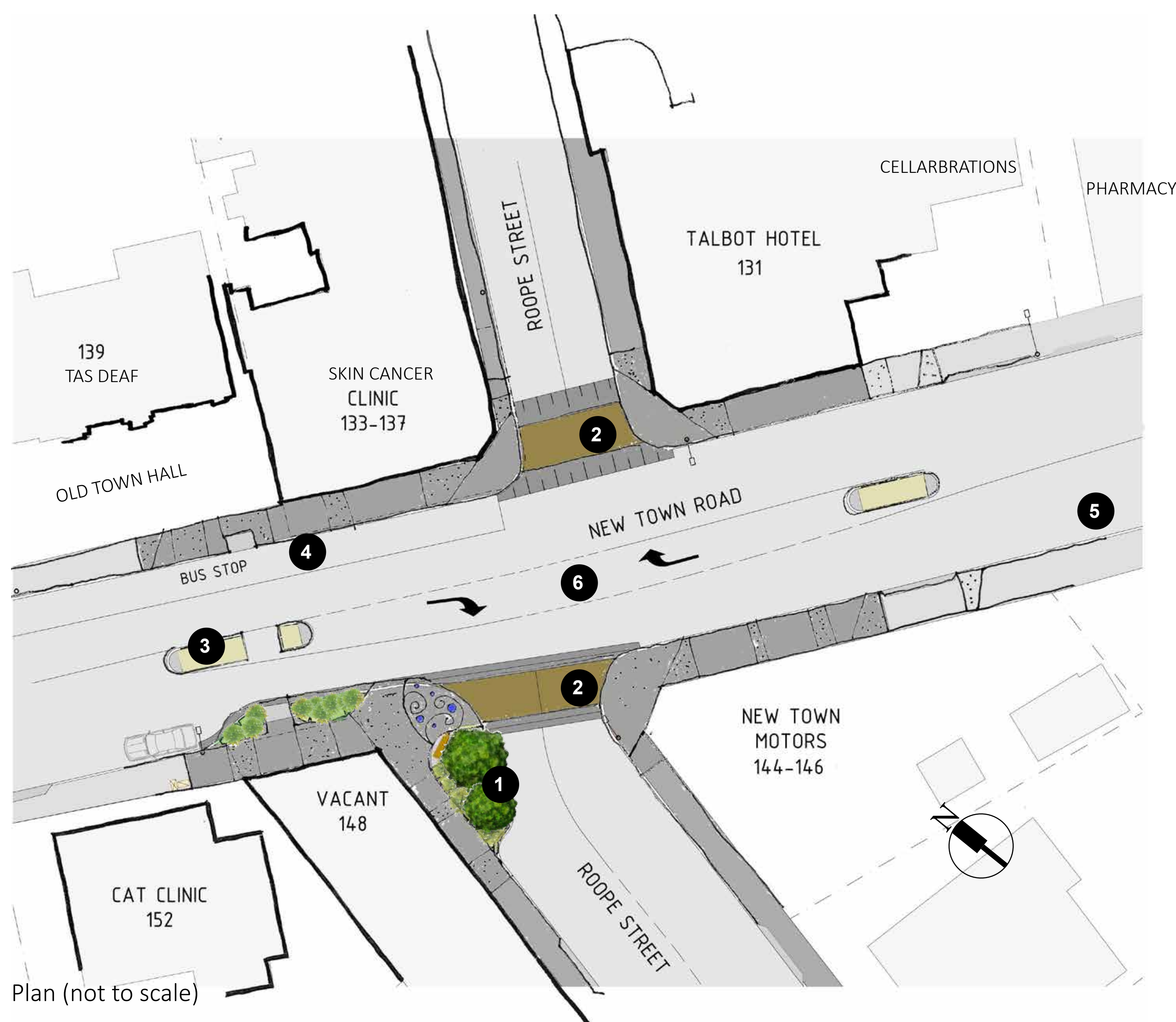

The changes proposed for the Roope Street area are focused on improving pedestrian access - across New Town Road and Roope Street - and improving the traffic arrangements at this intersection.

- 1 A small parklet** can be created by extending the footpath into Roope Street providing space for trees, low planting and seating.
- 2 Raised thresholds** will provide a level, step free path for pedestrians crossing Roope Street.
- 3 An improved pedestrian crossing facility** with median island and kerb outstand will improve pedestrian access across New Town Road.
- 4 Inbound bus stop** is proposed to remain in this location.
- 5 Outbound bus stop** is proposed to be removed from this location.
- 6 Right turn lanes** in the road will help to organise traffic movement.



Artist's Impression

Raised threshold example



Photo: Victoria Walks



Plant Palette

Clockwise from top left:
Lagerstroemia indica (Crepe Myrtle)
Dietes grandiflora
Kleinia mandraliscae (Blue Chalksticks)
Lomandra sp.



City of **HOBART**

Find out more & have your say...
yoursay.hobartcity.com.au/newtownprecinct

NEW TOWN RETAIL PRECINCT UPGRADE

Streetscape concept - Salvos mid-block crossing and pocket park



Community engagement revealed a strong desire for a pedestrian crossing facility in this busy mid-block location. The existing garden on the Salvos' site is an opportunity to provide a small space for people to gather. Street trees and plantings will enhance the presentation of this area and create a green gateway to the busy central hub of the retail precinct.

1 A new mid-block pedestrian crossing facility is proposed on New Town Road connecting the Salvation Army and New Town Greenstore. A median island and kerb outstands will make it easier for people to cross the road.

2 The existing garden at the front of the Salvation Army is re-imagined as a **cheerful pocket park** - open to the public and a place for rest, play and community activities.

3 **Seating, feature paving, bike parking, a water bubbler and planting** will make this area a more vibrant and attractive place. Exact locations to be determined in consultation with adjacent traders.

4 **A short section of bicycle lane** avoids a 'pinch point' for cyclists in the uphill direction alongside the median island. Note: a continuous bicycle lane is not proposed due to constraints of the road width.

Find out more & have your say...
yoursay.hobartcity.com.au/newtownprecinct



5

NEW TOWN RETAIL PRECINCT UPGRADE

Streetscape concept - Pirie Street junction

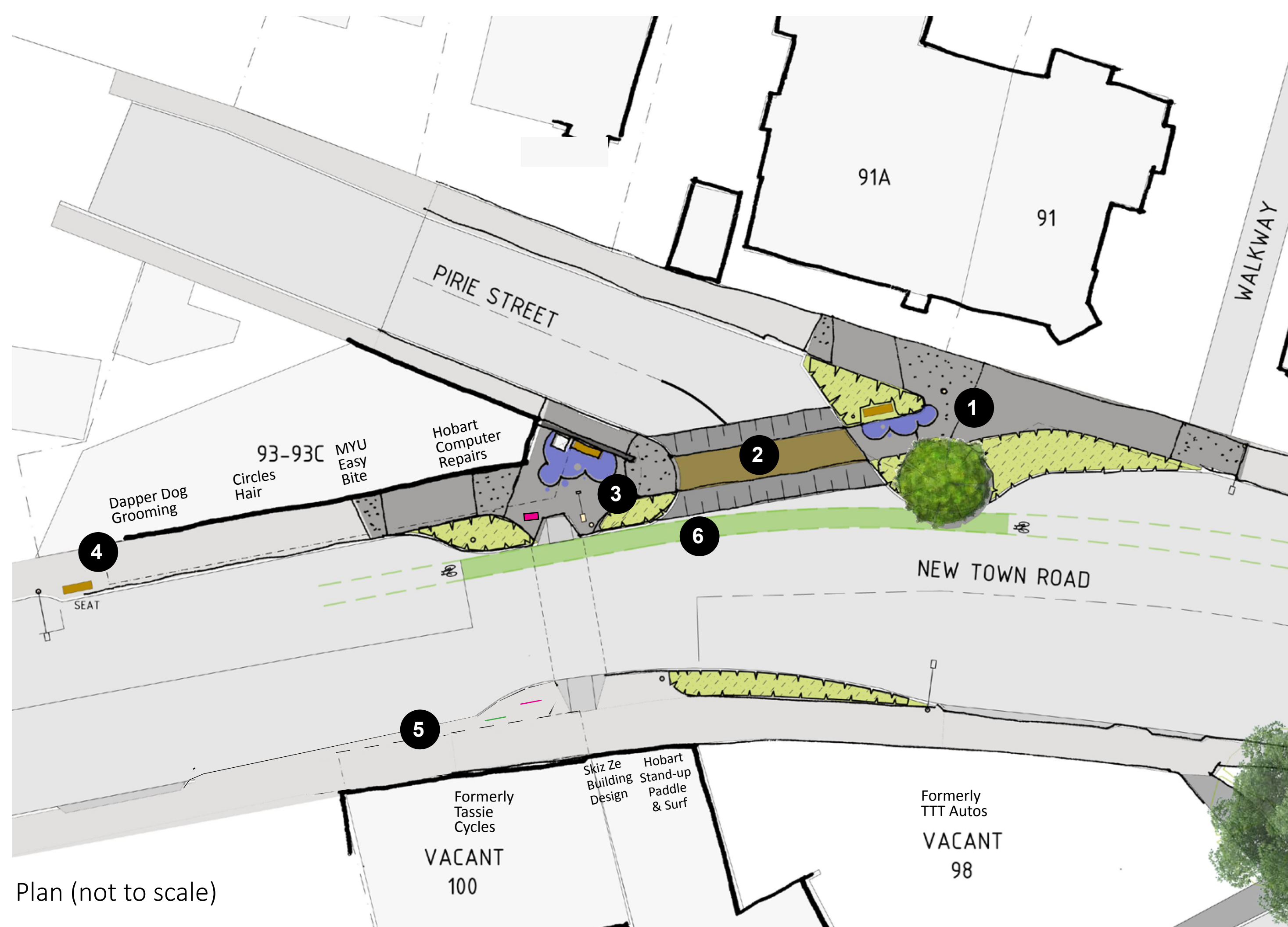

Plan (not to scale)

The Pirie Street corner is the **Southern Gateway** of the New Town retail precinct. A raised side street crossing, planting and bench seating will improve pedestrian access and comfort, and enhance the presentation of the street.

- 1 A resting place with seating, planting, a deciduous feature tree and feature paving.
- 2 A raised threshold combined with kerb bulbing to improve the alignment of the junction will improve pedestrian access.
- 3 A seat, planting, feature paving and artwork on the existing traffic signal box will enhance this area.
- 4 The inbound bus stop will remain in this location. A bench seat will be installed near the bus stop (final location to be determined).
- 5 Planting, renewed paving and bicycle parking will enhance amenity.
- 6 A bicycle lane is proposed in the city-bound direction between Pirie Street and Argyle Street on New Town Road.

Find out more & have your say...
yoursay.hobartcity.com.au/newtownprecinct

Artist's Impression



Street elements



Traffic signal box art, colourful bike racks

Plant Palette



Clockwise from top left:
Lagerstroemia indica (Crepe Myrtle)
Kleinia mandraliscae (Blue Chalksticks)
Dietes grandiflora
Lomandra tanika



City of **HOBART**

NEW TOWN RETAIL PRECINCT UPGRADE

Streetscape concept - Pedder Street junction



Pedder Street is the southern point of the project area. The distinctive stand of mature Eucalyptus trees are a landmark at the approach to the New Town precinct from the south.

- 1 A raised threshold combined with kerb bulbing to narrow the side street will improve the accessibility of this crossing.
- 2 Low planting and a bench seat will provide a comfortable place for pedestrians to rest.

Raised threshold example



Photo: Victoria Walks

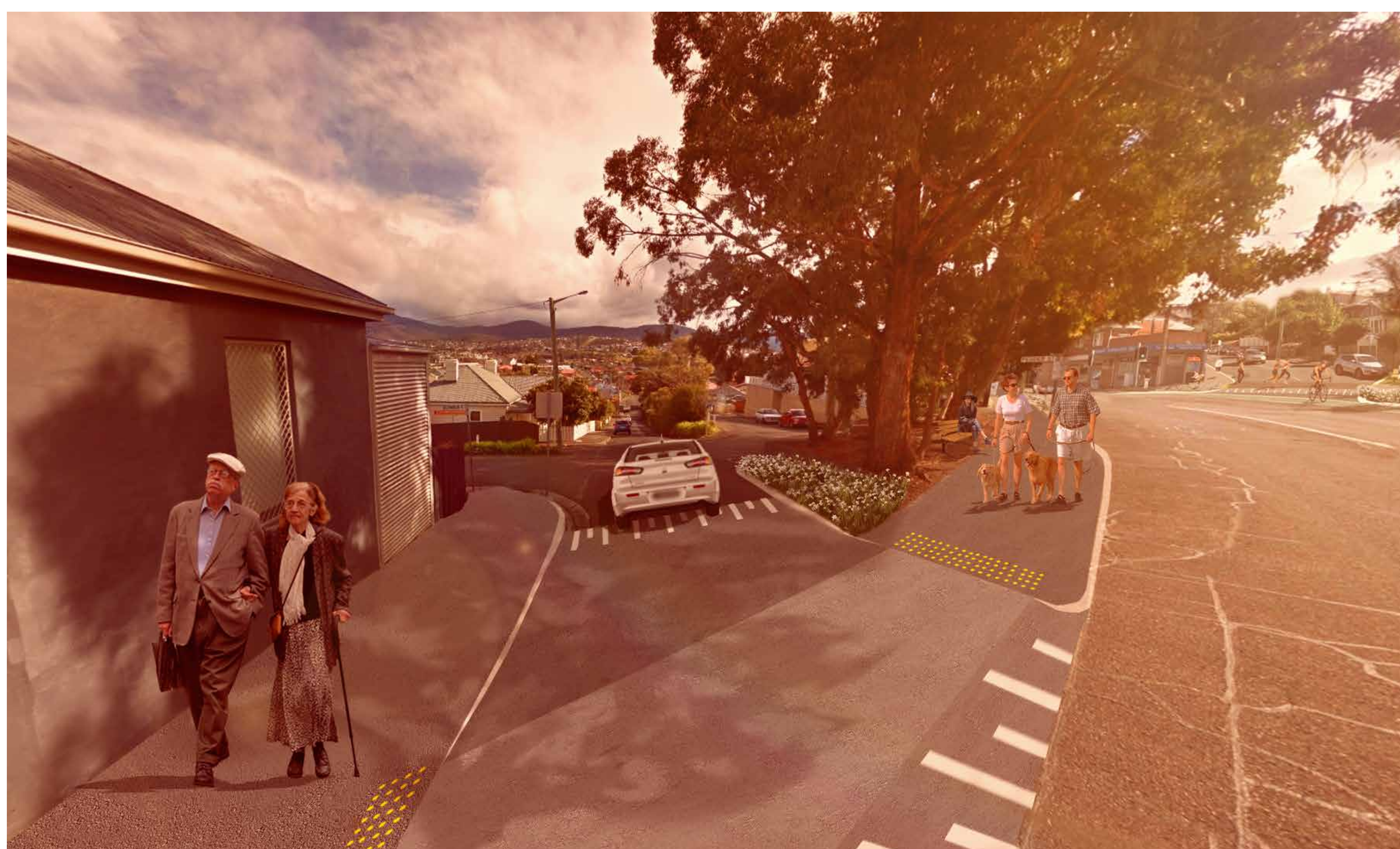

Artist's Impression

Find out more & have your say...
yoursay.hobartcity.com.au/newtownprecinct



City of **HOBART**