

IMPORTANT NOTES:

- CONTRACTOR/PROJECT MANAGER TO CHECK ALL DIMENSIONS ON SITE PRIOR TO COMMENCEMENT OF WORKS.
- THIS DRAWING IS TO BE READ IN CONJUNCTION WITH THE STANDARD DETAILS PACKAGE AND SCHEDULES.

01 ELEVATION- EXTERNAL
Scale: 1:50

ISSUE	DESCRIPTION	DRAWN BY	DATE
A	FOR DA APPROVAL	CL	14.09.15

PROJECT ADDRESS:	SCALE:
80 LIVERPOOL ST HOBART, TASMANIA 7000	1:50 @A3
DRAWING TITLE:	DRAWING NO:
ELEVATIONS- INTERNAL & EXTERNAL	D200

LEGEND:
EXISTING WALLS C.O.S

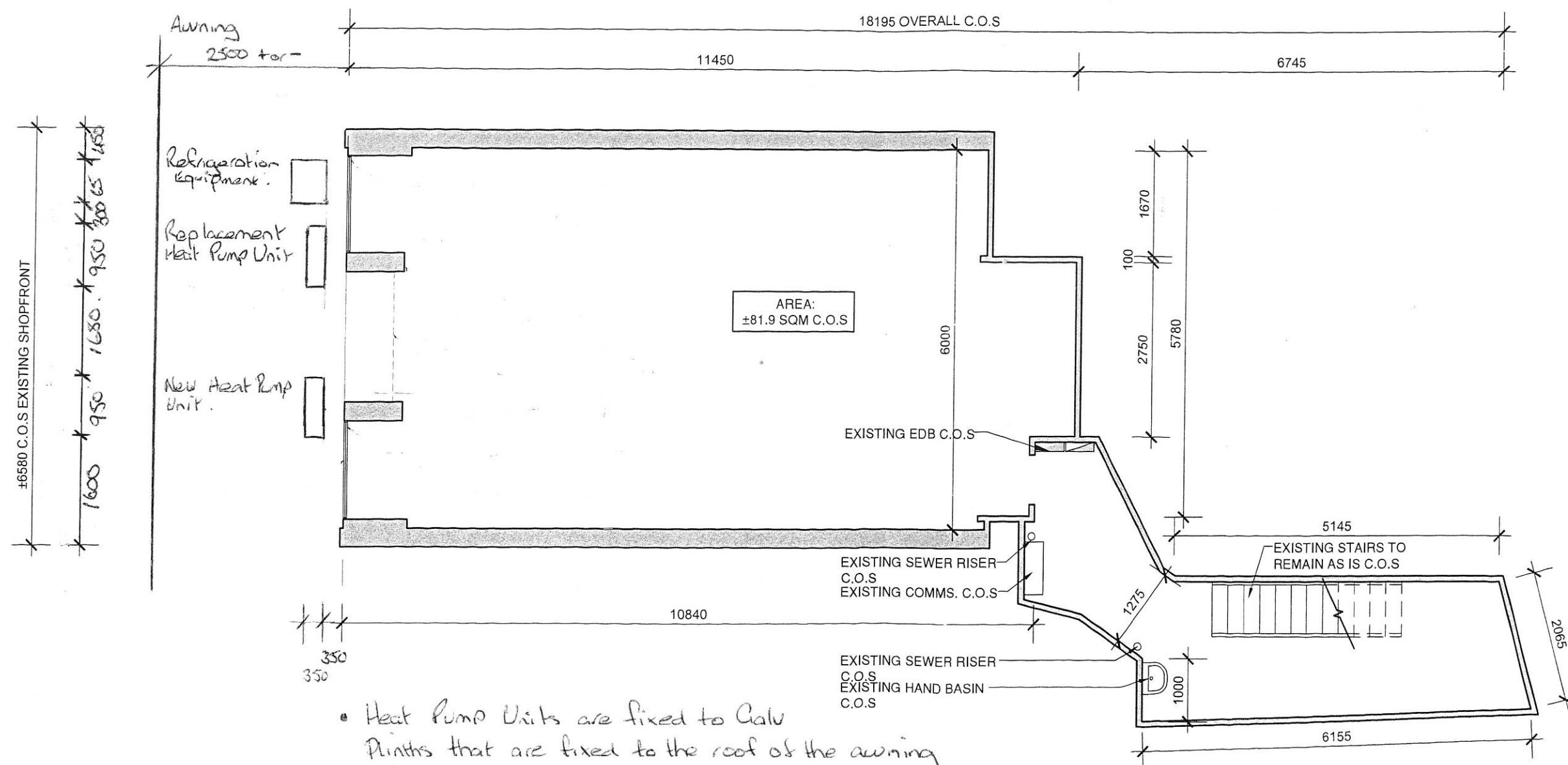

- Heat Pump Units are fixed to Galv Plinths that are fixed to the roof of the awning
- Refrigeration Unit is also located on the awning

PROJECT ADDRESS:
80 LIVERPOOL ST
HOBART, TASMANIA 7000
DRAWING TITLE:

SCALE:
1:75 @A3
DRAWING NO:





RESULT OF SEARCH

RECORDER OF TITLES

Issued Pursuant to the Land Titles Act 1980



SEARCH OF TORRENS TITLE

VOLUME 114057	FOLIO 1
EDITION 4	DATE OF ISSUE 15-Mar-2012

SEARCH DATE : 04-Jul-2016

SEARCH TIME : 10.37 AM

DESCRIPTION OF LAND

City of HOBART

Lot 1 on Plan 114057

Being the land described in Conveyance No. 29/9686

Derivation : Part of 0a-1r-6p Gtd. to Sarah Thomas & Edmund

Stillwell

Derived from A15311

SCHEDULE 1

D42218 TRANSFER to GEORGE GIAMEOS and PHYLLIS GIAMEOS
(jointly as between themselves) of one undivided 1/2
share and FIRST FLOOR HOLDINGS PTY LTD of one
undivided 1/2 share as tenants in common Registered
15-Mar-2012 at noon

SCHEDULE 2

Reservations and conditions in the Crown Grant if any
19/1807 CONVEYANCE Benefiting Easement: Right of Way over the
lands marked Right of Way on Plan No. 114057

D42219 MORTGAGE to Commonwealth Bank of Australia
Registered 15-Mar-2012 at 12.01 PM

UNREGISTERED DEALINGS AND NOTATIONS

No unregistered dealings or other notations

FILE NUMBER A.15311		CONVERSION PLAN		REGISTERED NUMBER P 114057	
GRANTEE PART OF OR. 12. 6P GTD TO SARAH THOMAS & EDMUND STILLWELL.		LOCATION CITY OF HOBART (SEC N)		APPROVED - 2 NOV 1994 <i>Michael Dine</i> Recorder of Titles	
		CONVERTED FROM 42/1966			
		NOT TO SCALE		LENGTHS IN METRES	
MAPSHEET MUNICIPAL CODE No. 21		LAST UPI No.		ALL EXISTING SURVEY NUMBERS TO BE CROSS REFERENCED ON THIS PLAN	
				DRAWN DJB	

SKETCH BY WAY OF ILLUSTRATION ONLY
"EXCEPTED LANDS"

11.34 TO ELIZABETH ST (PER 19/1807)

6.56

10.51

1.52

1.09

3.05

2.79

(P. 12418)

5.97

6.78

2.31

1.40

1.93

1.70

10.57

101m²

(8/26 Hob)

LIVERPOOL STREET

RIGHT OF WAY

15.47

5.79

19.46

RIGHT OF WAY

HOBART RIVULET

(P. 440 (120))

0.86

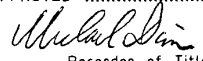
FILE NUMBER A.15311 GRANTEE PART OF OR IR 6P GTD TO SARAH THOMAS & EDMUND STILLWELL.		CONVERSION PLAN LOCATION CITY OF HOBART (SEC N) CONVERTED FROM 42/1966 NOT TO SCALE LENGTHS IN METRES		REGISTERED NUMBER P 114057
MAPSHEET MUNICIPAL CODE No. 21		LAST UPI No.		ALL EXISTING SURVEY NUMBERS TO BE CROSS REFERENCED ON THIS PLAN
				APPROVED - 2 NOV 1994  Recorder of Titles

SKETCH BY WAY OF ILLUSTRATION ONLY

"EXCEPTED LANDS"

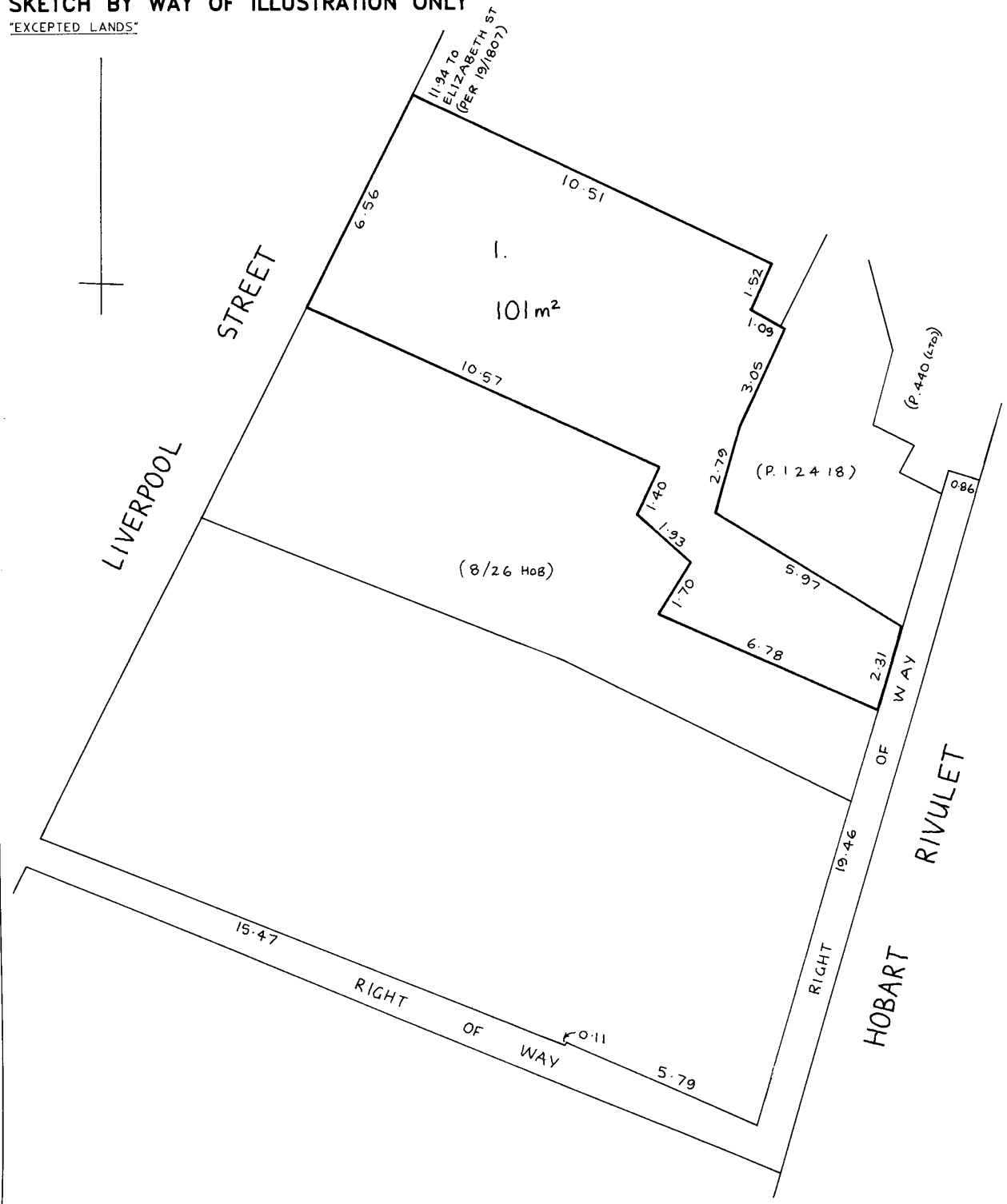

A-183