

# LOCAL AREA TRAFFIC MANAGEMENT

## Hill Street West Hobart Pedestrian Improvements

# TRANSFORMING HOBART

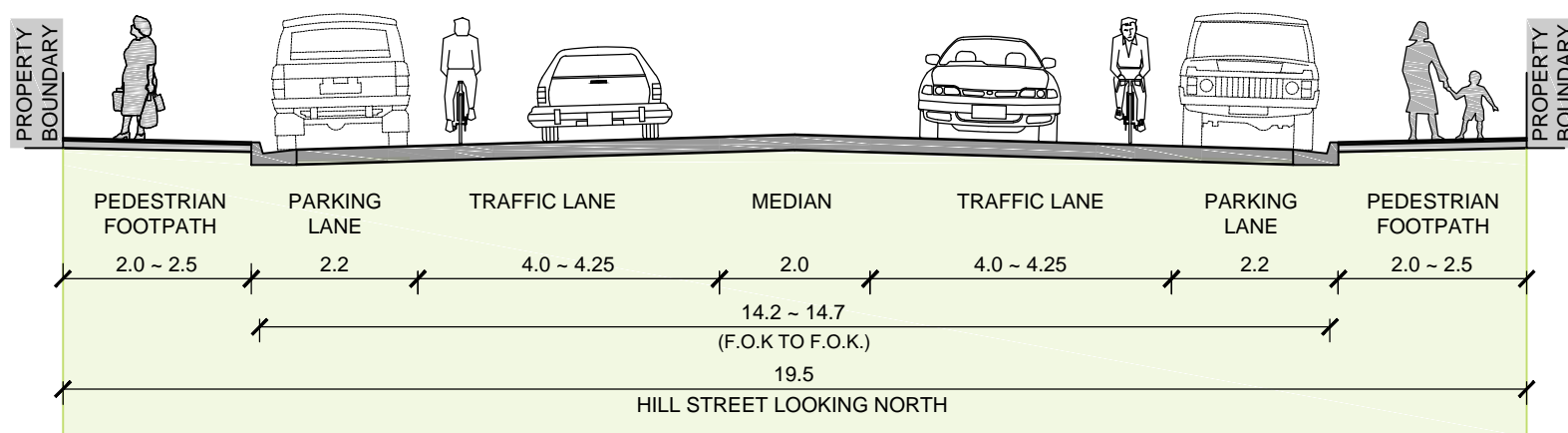
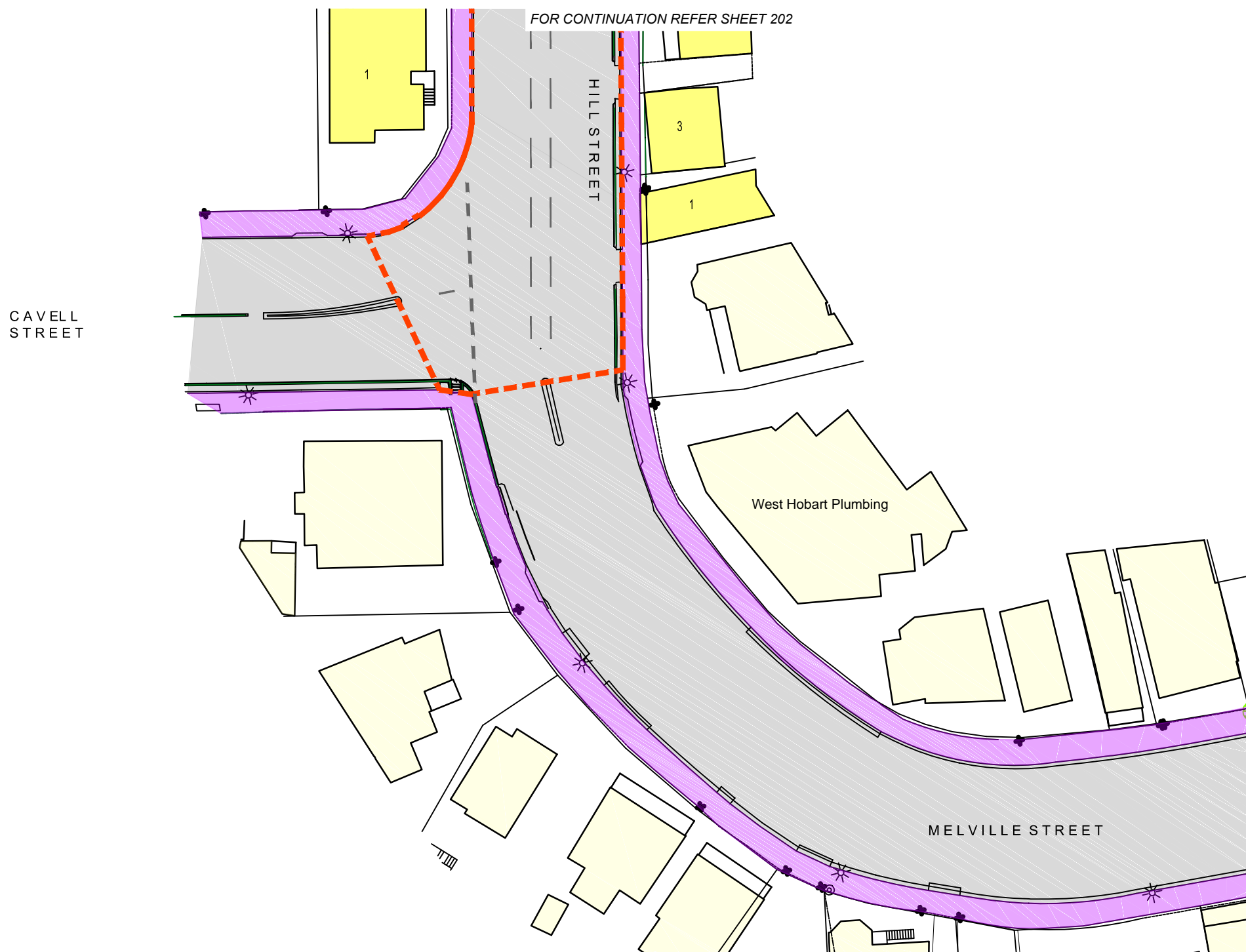

**TYPICAL STREET CROSS SECTION - NON CROSSING POINT**

NOT TO SCALE

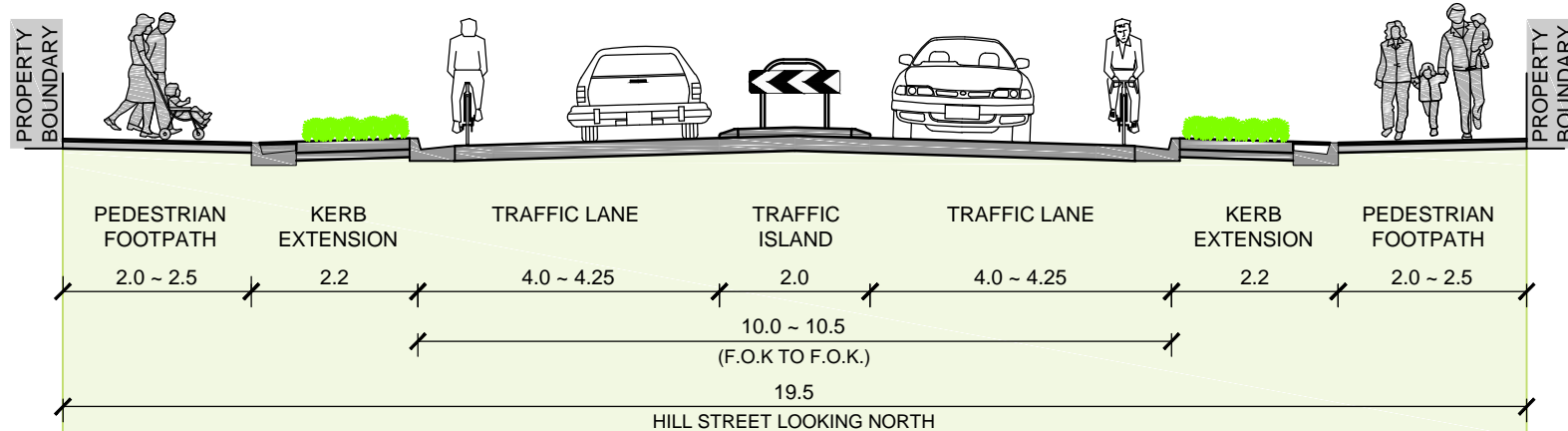

**TYPICAL STREET CROSS SECTION - CROSSING POINT**

NOT TO SCALE

### PROJECT DRIVERS

- Improved pedestrian crossing opportunities on Hill Street.
- Reduce traffic speeds

### DESIGN FEATURES

Four improved pedestrian refuge island crossing points to improve safety for people crossing Hill Street.

SHEET 201



City of **HOBART**

# LOCAL AREA TRAFFIC MANAGEMENT

## Hill Street West Hobart Pedestrian Improvements

TRANSFORMING  
**HOBART**

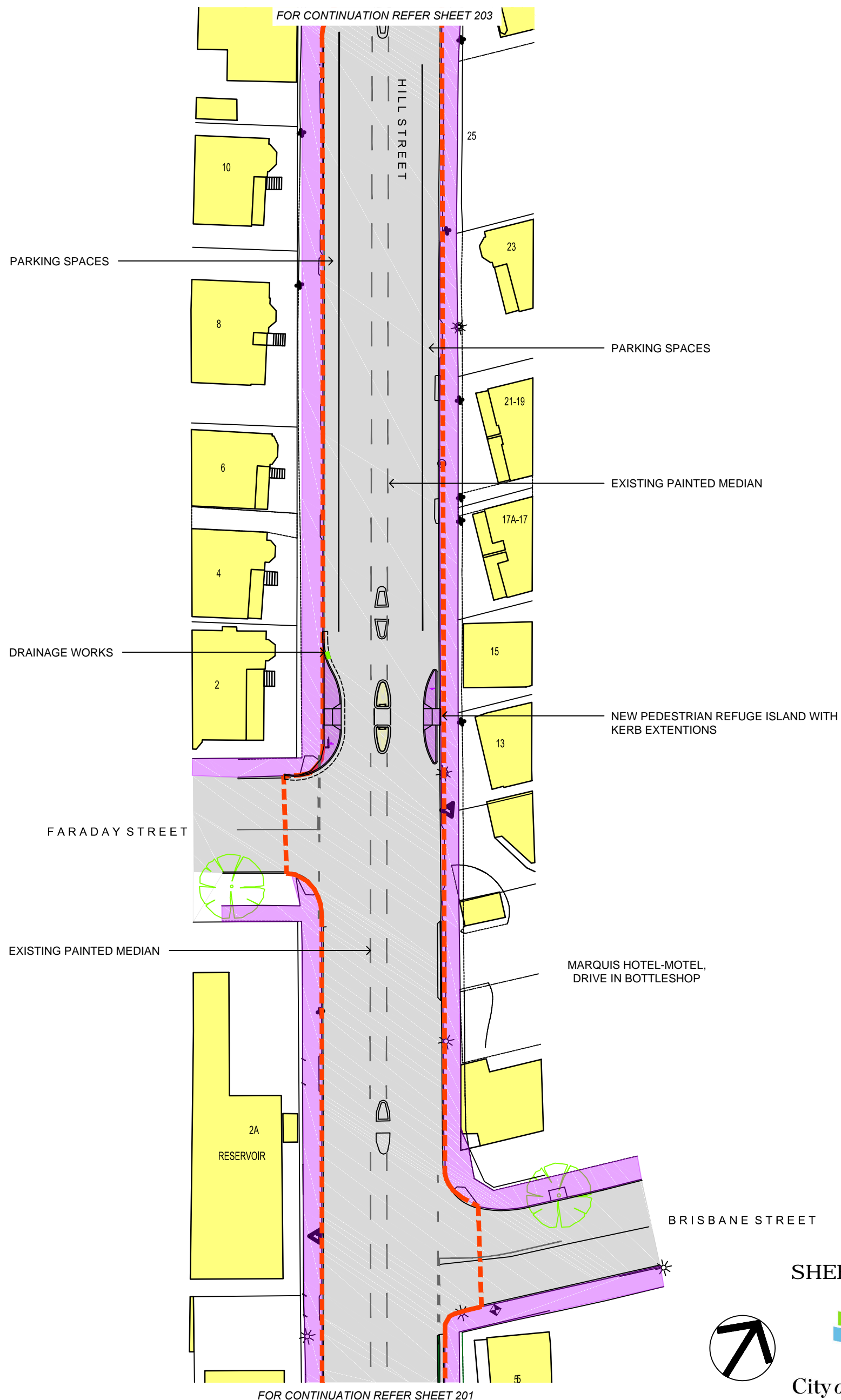

SHEET 202



City of **HOBART**

# TRANSFORMING HOBART



# LOCAL AREA TRAFFIC MANAGEMENT

## Hill Street West Hobart Pedestrian Improvements

TRANSFORMING  
**HOBART**

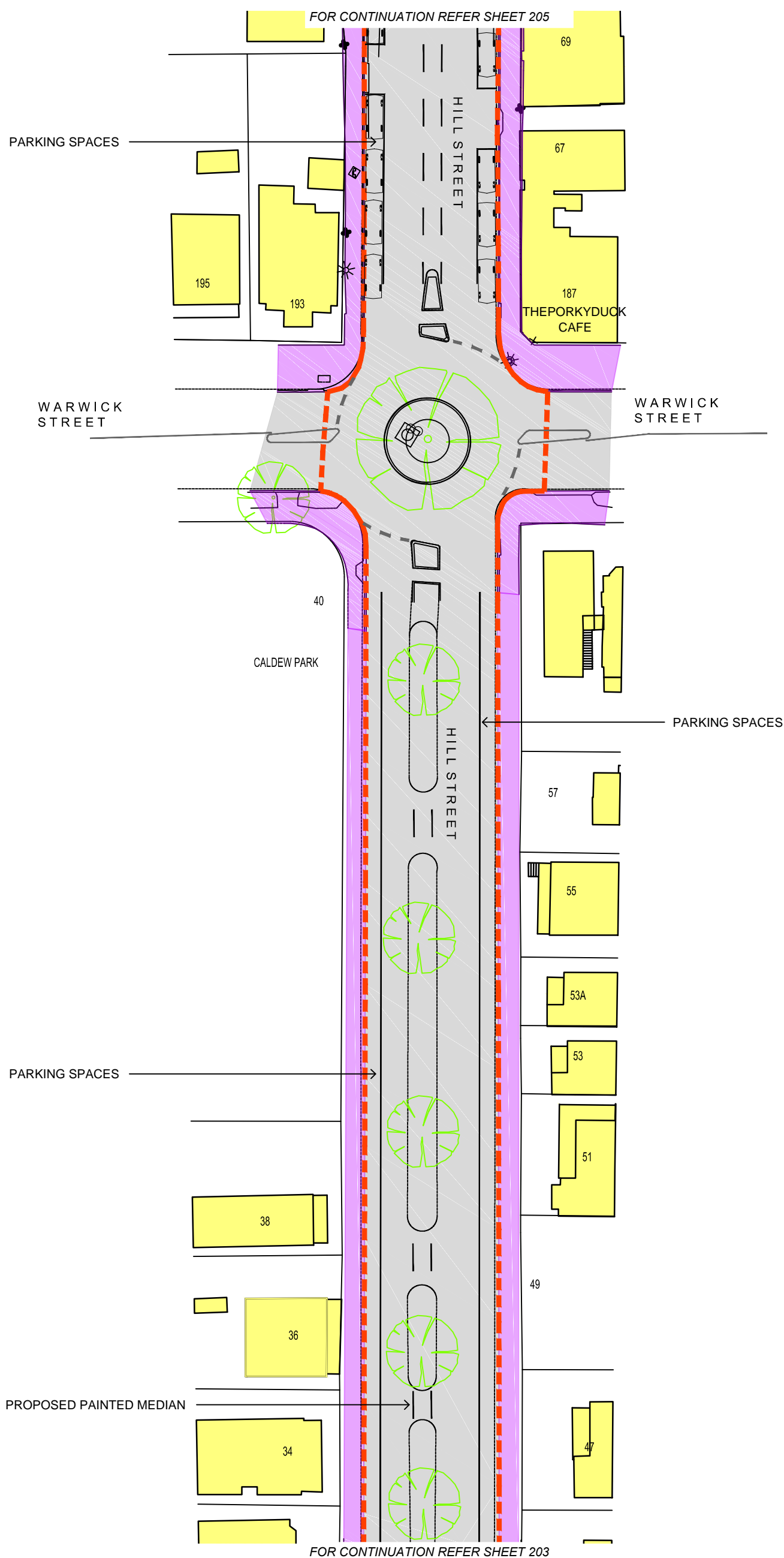

SHEET 204



City of **HOBART**



# LOCAL AREA TRAFFIC MANAGEMENT

## Hill Street West Hobart Pedestrian Improvements

TRANSFORMING  
**HOBART**

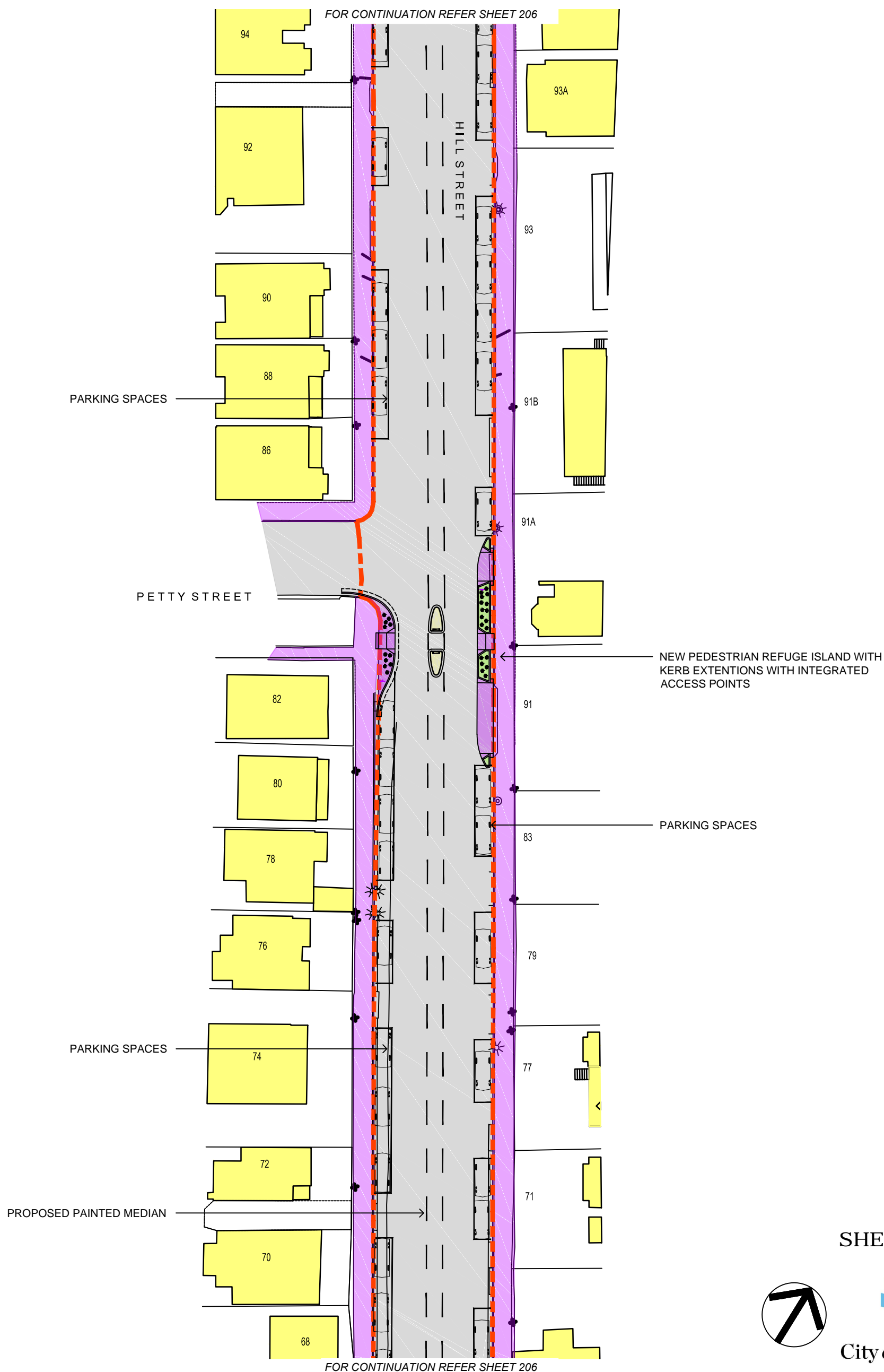

SHEET 205



City of **HOBART**

# LOCAL AREA TRAFFIC MANAGEMENT

## Hill Street West Hobart Pedestrian Improvements

TRANSFORMING  
**HOBART**

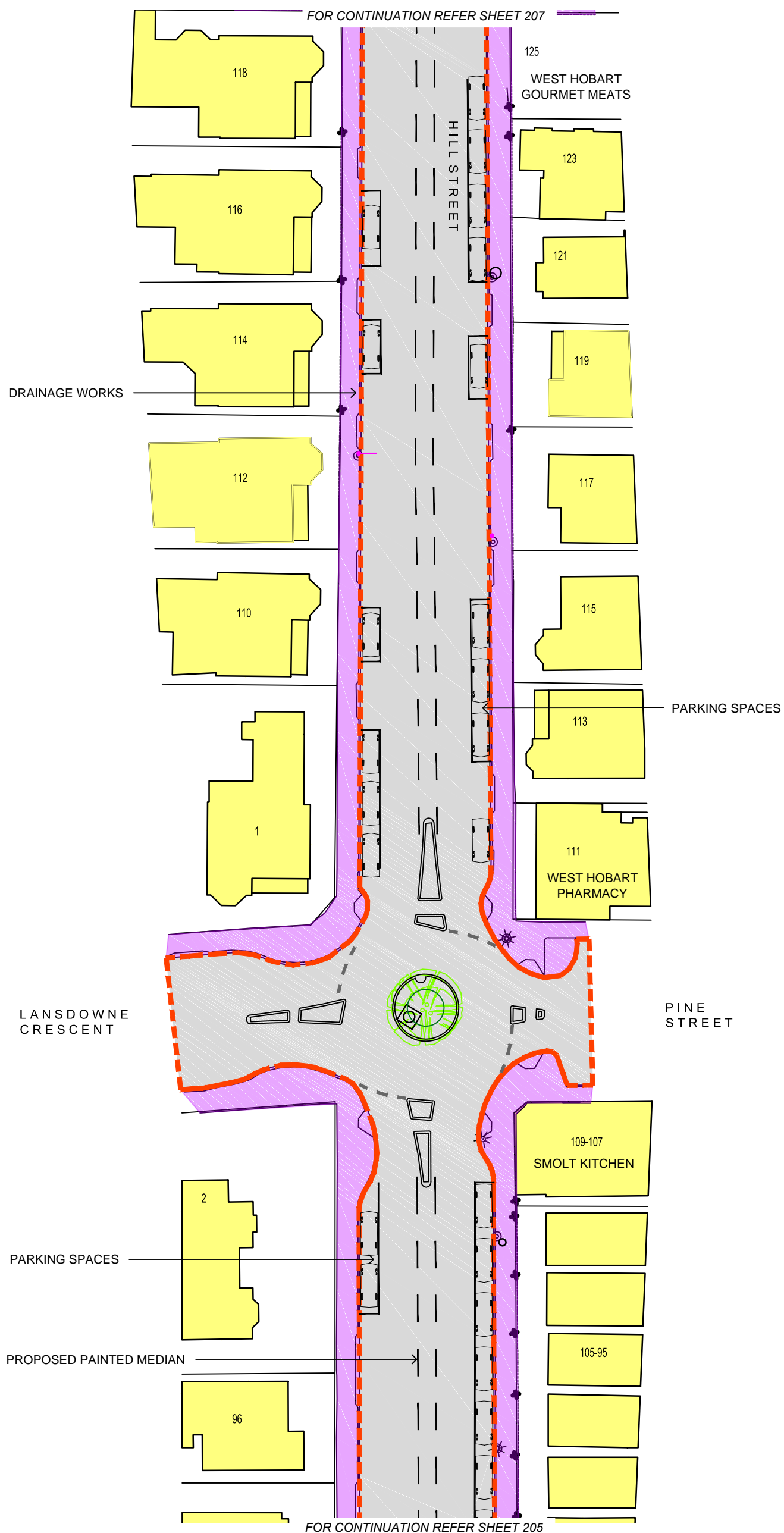

SHEET 206



City of **HOBART**

# LOCAL AREA TRAFFIC MANAGEMENT

## Hill Street West Hobart Pedestrian Improvements

# TRANSFORMING HOBART

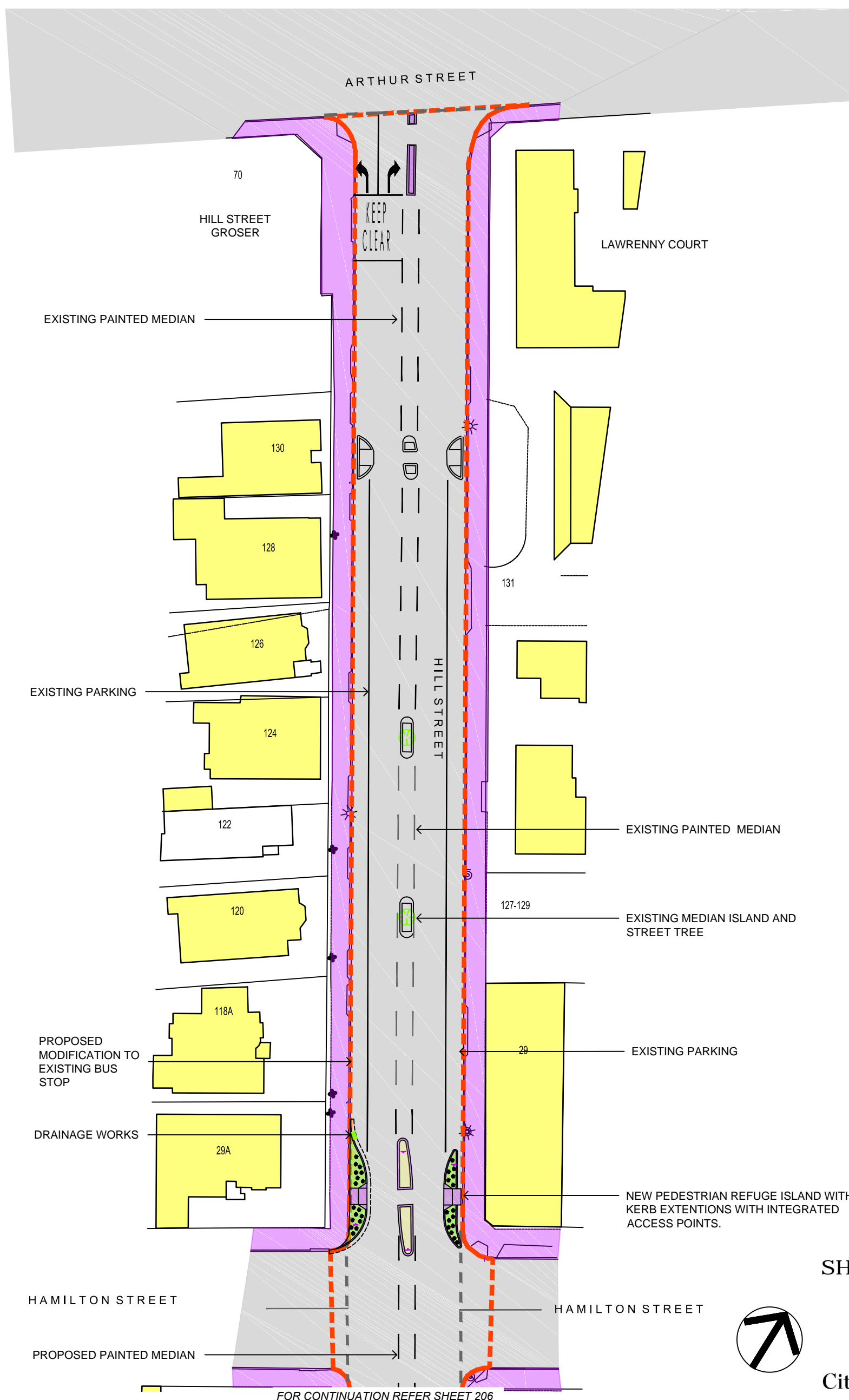

SHEET 207



City of **HOBART**



# LOCAL AREA TRAFFIC MANAGEMENT

## Hill Street West Hobart Pedestrian Improvements

# TRANSFORMING

## HOBART

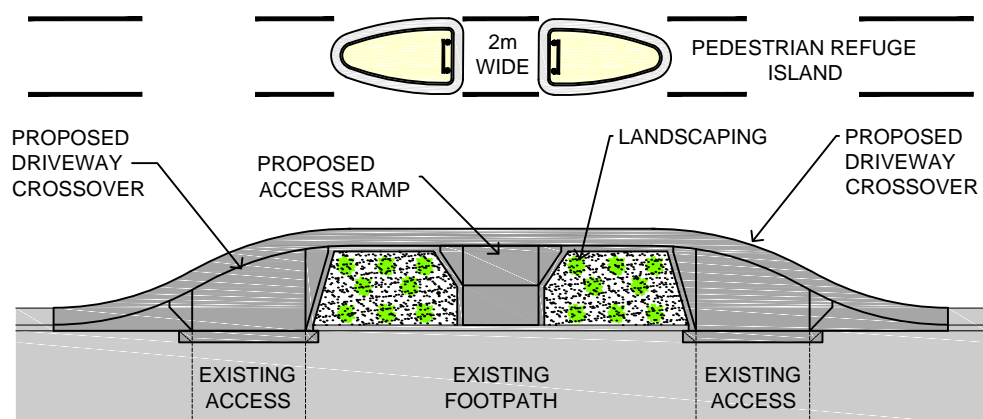

Indicative integrated kerb extension

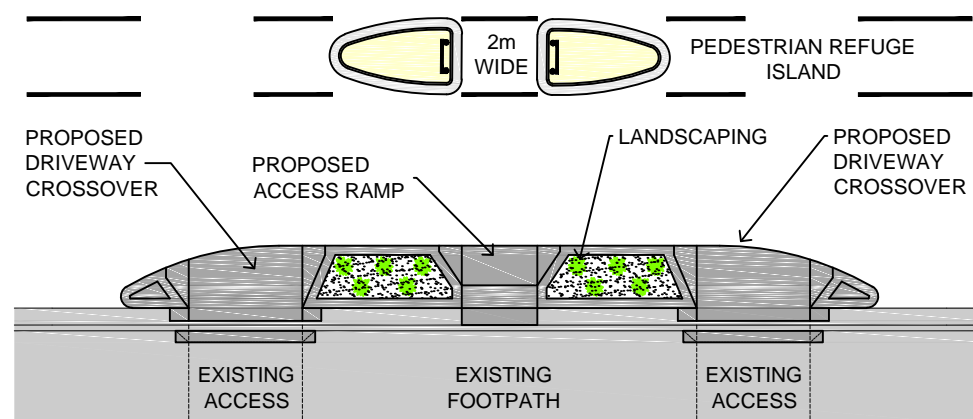

Indicative non-integrated kerb extension



Integrated kerb extension concept - For illustrative purposes only

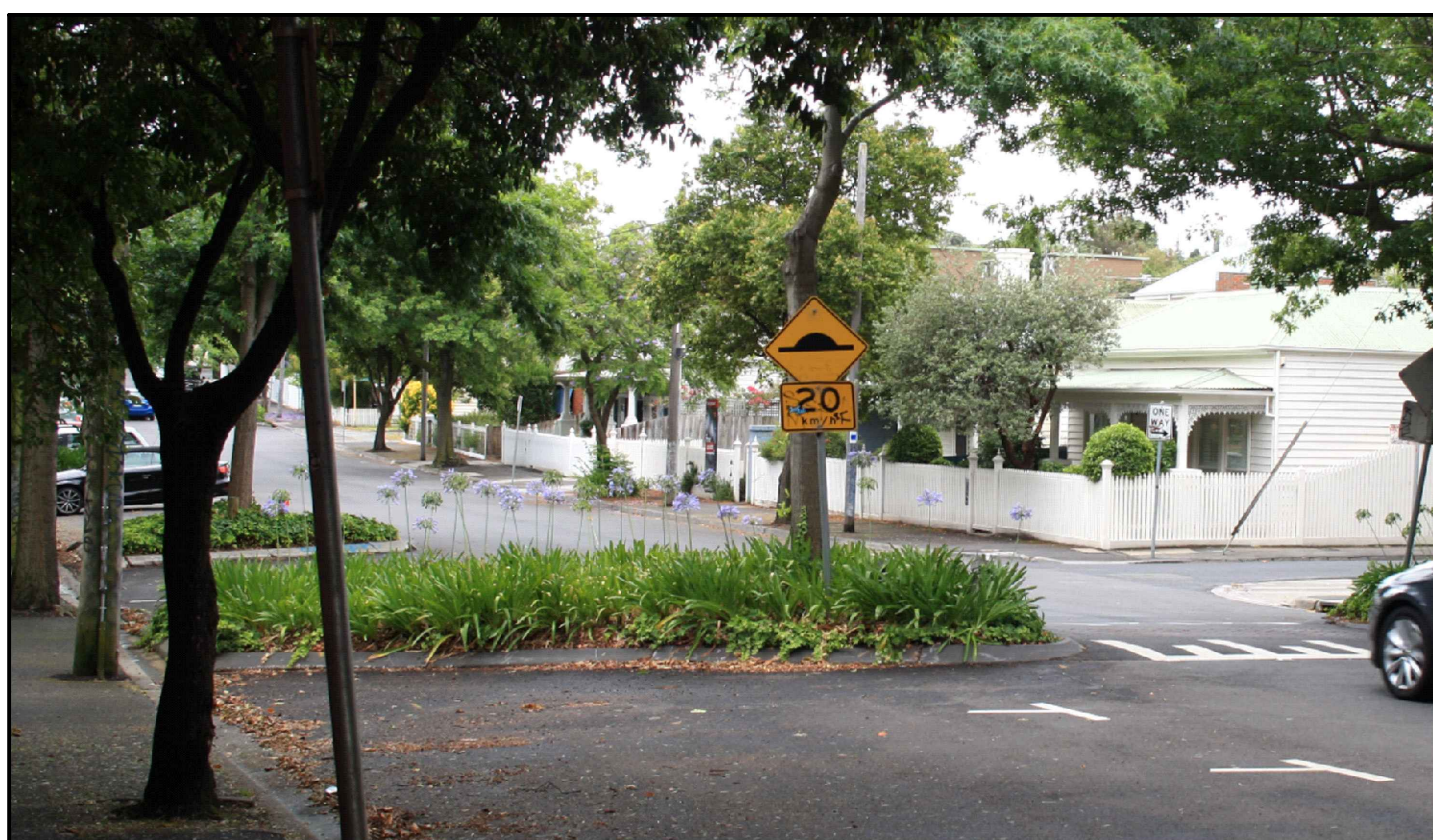

Non-integrated kerb extension concept - For illustrative purposes only

SHEET 208



City of **HOBART**